

SITE PLAN
SCALE 1:1250 @ A1

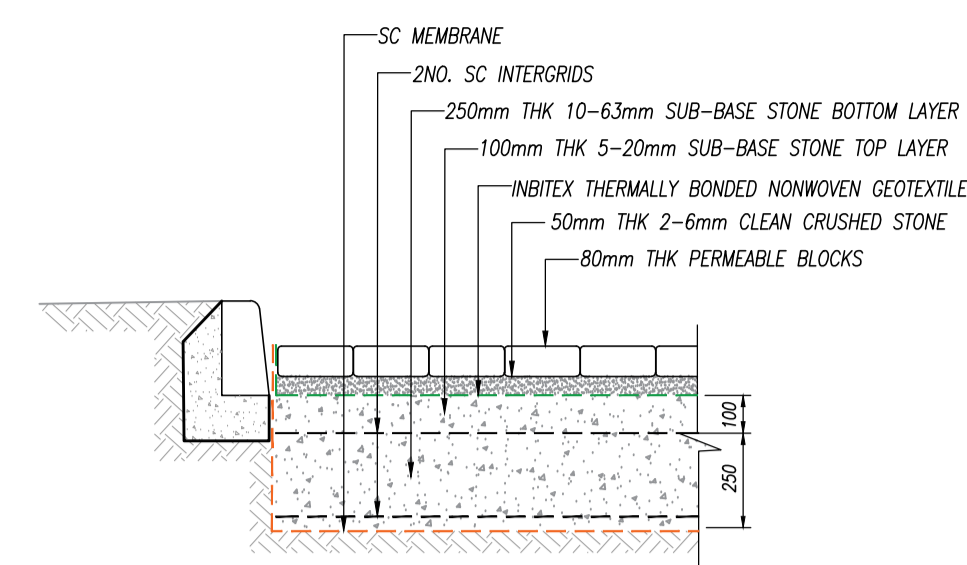

PERMEABLE PAVING SYSTEM BUILD-UP TYPICAL DETAIL
N.T.S. @ A1

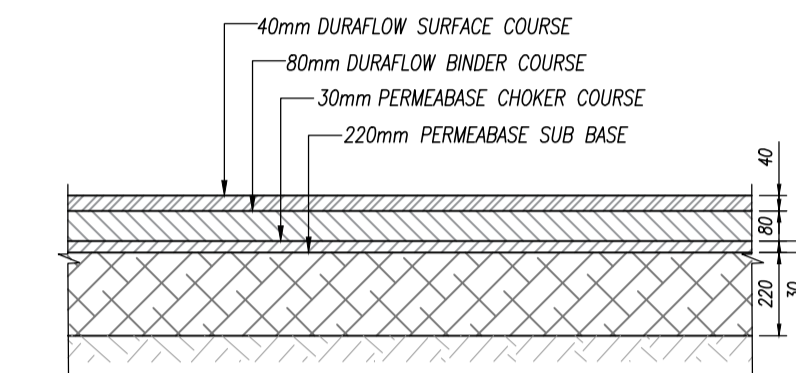

ALTERNATIVE PERMEABLE SURFACE SYSTEM BUILD-UP TYPICAL DETAIL
N.T.S. @ A1

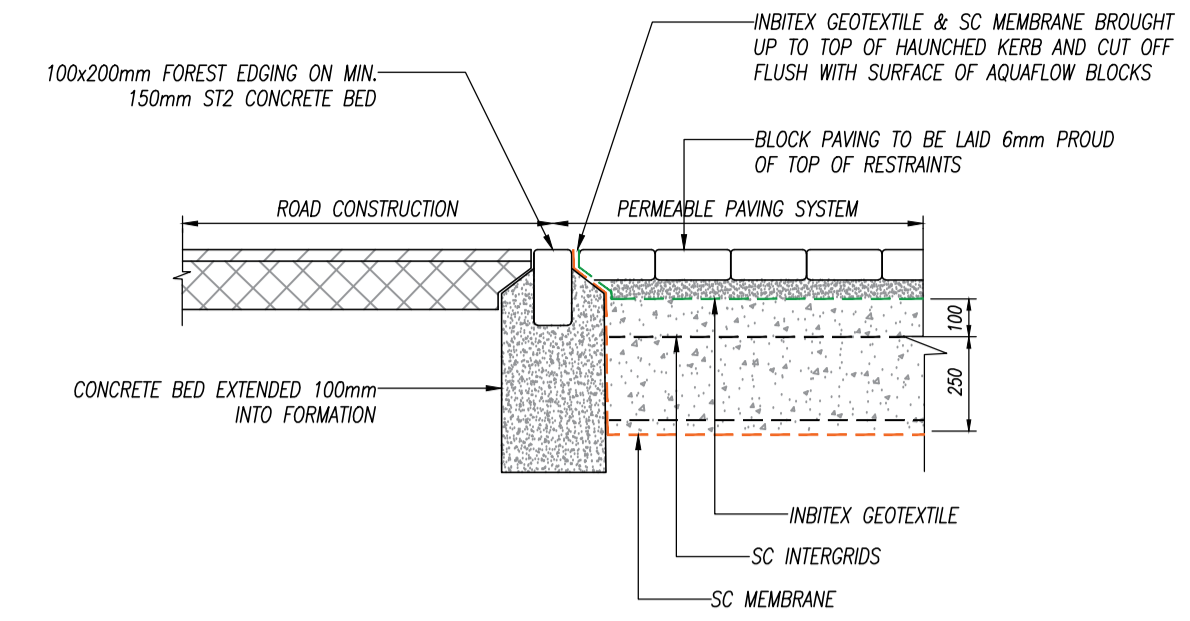

PERMEABLE PAVING FULL HEIGHT RESTRAINT TYPICAL DETAIL
N.T.S. @ A1

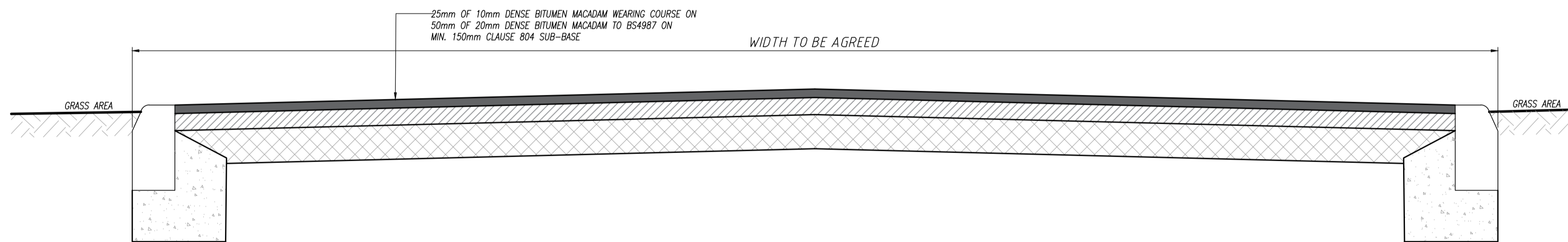

GREENWAY/SHEEPMORE LANE CONNECTION TYPICAL SECTION
SCALE 1:10 @ A1

N.B. WORKS SUBJECT TO AGREEMENT TO BE PROVIDED BY OR ON BEHALF OF THE LOCAL AUTHORITY.

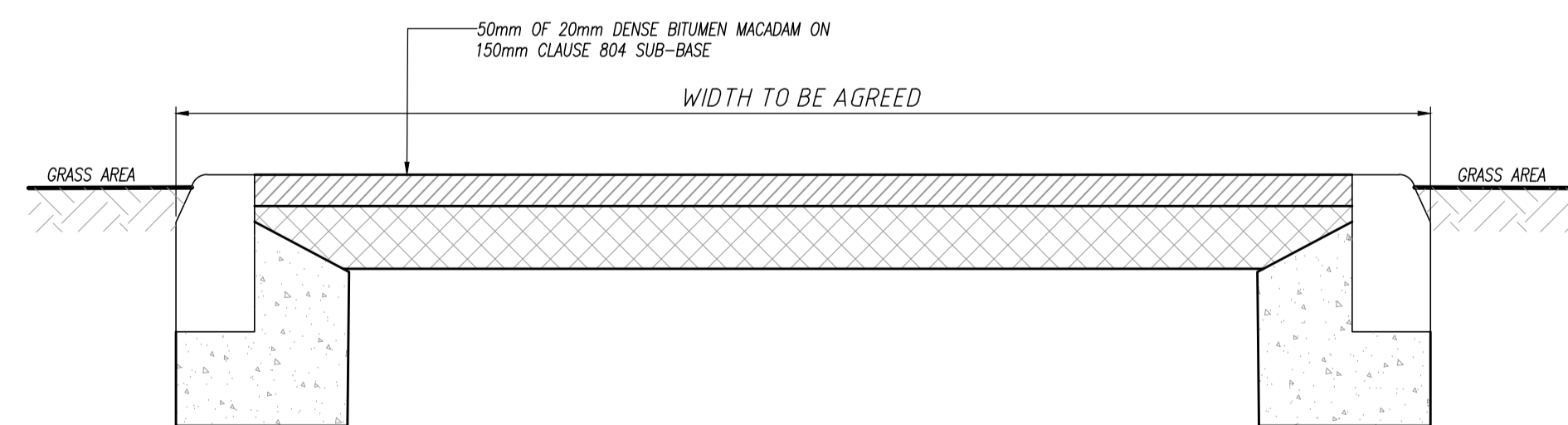

PEDESTRIAN WAY/DISWELLSTOWN ROAD CONNECTION TYPICAL DETAIL
SCALE 1:10 @ A1

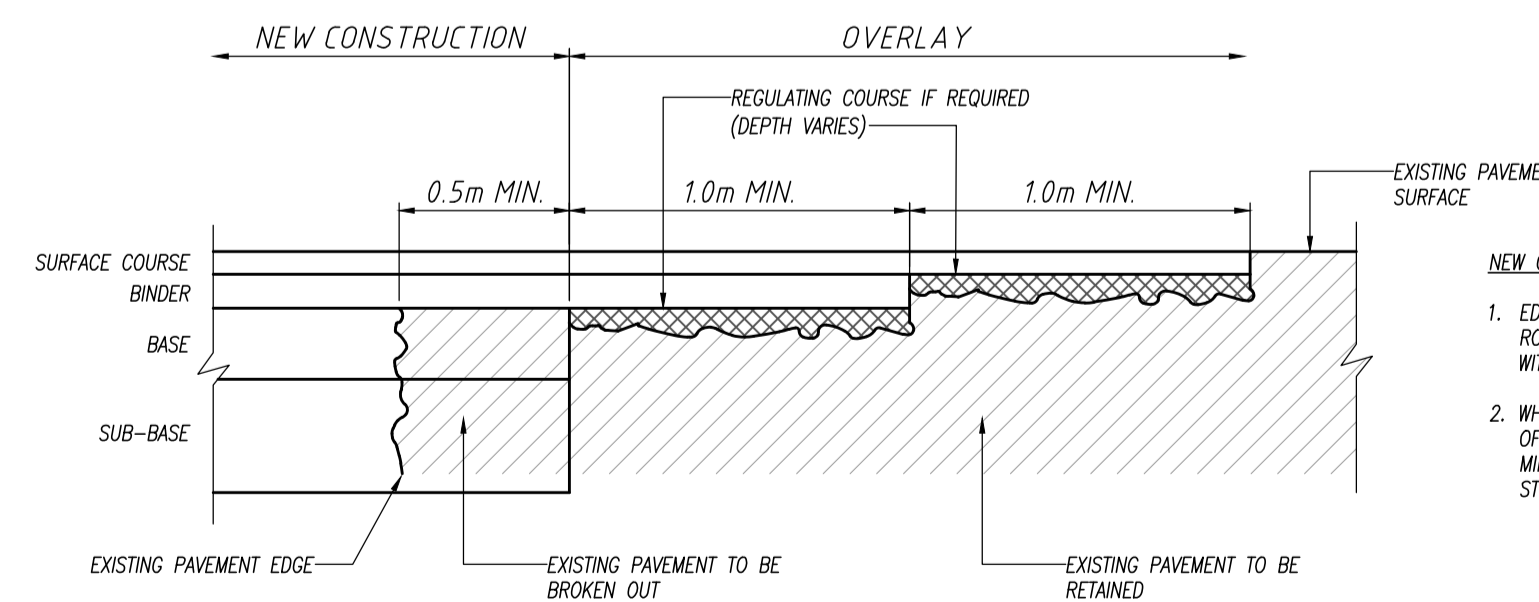

TRANSVERSE JOINT BETWEEN NEW CONSTRUCTION AND EXISTING ROAD TYPICAL DETAIL
N.T.S.

NEW CONSTRUCTION/EXISTING ROAD NOTES:

- EDGES OF EXISTING CARBAGWAY TO BE CUT BACK BY 0.5m WITH A ROTARY SAW TO FORM A VERTICAL FACE AND PRIMED IN ACCORDANCE WITH CLAUSE 903.
- WHERE THE BASE IS TO BE LAID IN TWO LAYERS, THE UPPER LAYER OF BASE SHOULD BE STEPPED INTO THE EXISTING PAVEMENT BY 1.0m MINIMUM WITH THE BINDER AND SURFACE COURSE TO BE EACH STEPPED IN A FURTHER 1.0m MINIMUM RESPECTIVELY.

NOTES

- THIS DRAWING IS TO BE READ IN CONJUNCTION WITH ALL OTHER APPROPRIATE DRAWINGS AND SPECIFICATIONS.
- DO NOT SCALE, USED FIGURED DIMENSIONS ONLY.
- ARCHITECTURAL LAYERS RECEIVED FROM MCCROSSAN O'ROURKE MANNING ARCHITECTS, 1 GRANTHAM STREET, DUBLIN 6, D08 A49Y. TEL : 01 478 8700 EMAIL : arch@mccorm.ie
- DETAILED DESIGN OF THE PROPOSED GREENWAY IS SUBJECT TO AGREEMENT WITH THE PLANNING AUTHORITY.

REV.	DATE	AMENDMENT	DRN	APPD

STATUS **FOR PLANNING ONLY**



Office 6 Burrell Court, Mayne River Road East,
Malahide Road, Dublin 17, D17 RX47



CLIENT	KIMPTON VALE LTD
ARCHITECT	MCCROSSAN O'ROURKE MANNING ARCHITECTS
PROJECT	WINDMILL, PORTERSTOWN, CLONSILLA, DUBLIN 15

TITLE ROADS, CYCLE & PEDESTRIAN PATHS DETAILS
SHEET 2 OF 2

DRAWN AMT	DESIGNED AMT	APPROVED SMQ	DATE 03/10/2019
SCALE AS SHOWN @A1	JOB NO. 18-178	DRG. NO. P010	REVISION

© This drawing is copyright. No part of this document may be reproduced or transmitted in any form or stored in any retrieval system of any nature without the written permission of the consulting engineer or copyright holder except as agreed for use on the project for which the document was originally issued.